

Series N110 Multifunction Surface Mount Meter

Hour meter with Automatic Maintenance Functions



- Monitor Run Hours, RPMs(1-2 Cylinders), and Maintenance Requirements on Gasoline Engines.
- Available with GDI Flash Alert™ service reminders, cycle counter, power up/down message, and more!
- Easy Installation with patented 1 wire inductive hookup, self powered.



GDI Surface Mounted meters are the perfect maintenance solution for monitoring and properly maintaining any gas powered equipment. This meter is highly customizable and can include functions such as an hour meter, automatic service alerts with break in intervals, cycle counter, power up/down message and more.

Knowing what to service and when to service is the key to a successful maintenance program—GDI meters with Flash Alert™ makes this possible! With GDI Flash Alert, the LCD display will flash **What** service to perform and **When** to perform it. The user can see how many hours are remaining until service is required, or if a service is required NOW. The Alert intervals reset automatically after the specified warning time out. Up to 3 Flash Alerts with breakin intervals are available. Standard or custom service messages are also available.

Solid state electronics, modern LCD, competitive costing, superb environmental durability and enhanced functionality offer today's leading Maintenance firms and OEMs the best of all possibilities without sacrifice to performance, operation, or budget.

Features at a glance:

- Total run time Hour meter
- 3 Automatic Service Alerts with Breakin interval and reset options.
- Inductive Tachometer for 1 and 2 cylinder Gasoline engines
- Power up message
- Power down message
- Stock and customer messages
- LCD Display always lit
- 1 wire Inductive hookup (simply wrap the pickup wire around the outside of a sparkplug wire or coil-in-plug module)
- 100% Environmentally sealed

Hour Meter & Timers

- Total run timer counts in tenths to 9,999.9, then whole hours up to 99,999 hours (non resettable)
- Resolution 0.1 hours
- Quartz accuracy: +/- 0.02% (over entire voltage & temperature range)

Flash Alert Option

- Three (3) Automatic Service Alerts (1 to 9,999 hour interval)
- One time Breakin interval option for each alarm (1 to 999 hours)
- Interval sync up option so multiple services come due at the same time
- Flash Alert trigger: (OEM can decide when to flash alerts on LCD regardless of what mode the meter is in, plus how often to flash).
- Standard and custom messages available.
- Note: Service alerts are count down intervals (run hours). The interval is the amount of run time until a service is due (Example, Change OIL every 25 hours). After the interval is reached, the LCD will show to Change OIL "NOW".



Power up or Power down message

- Messages can be displayed on the LCD on power up or power down of the equipment.
- The OEM specifies the message and how many times the message is repeated.
- For Example: on power up display "SEAT BELT" three times. (repeat can be 1-15 times)

New GEN SMT METER Hook Up

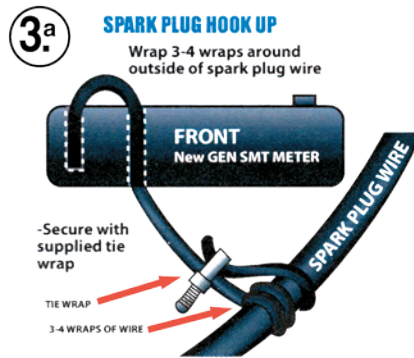
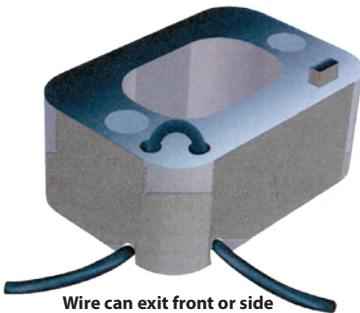
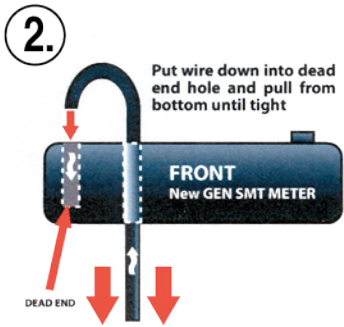
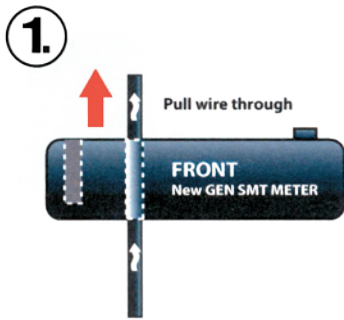

Mechanical Specification

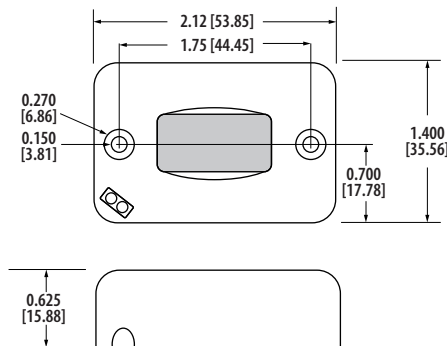

Environmental Specifications

- Meter power supply: Internal lithium battery - 3 volt (Li-MnO₂)
- Battery Life: >12 years
- Encapsulation: Internals 100% encapsulated
- LCD: Automotive Grade
- VA (Viewable Area): 12.7mm x 25.4mm
- Digit Height: 6mm
- Digits: 6
- Type: Positive Mode, TN
- Fluid: High Temp
- Polarizer Rear: High Temp Reflective
- Polarizer Front: High Temp, Transmissive (antiglare)
- Viewing Angle: 6 o'clock
- Backlight - NO
- PCB-LCD connection: DIL pin soldered to PCB
- Logging Response Time:
 - » Log ON: 1 second
 - » Log OFF: 1 second
- Average Log ON-Log OFF = 0
- Accuracy; +/- 0.01 % @ 25C
- Front Bezel: ABS - black housing (Polylac PA757) with Acrylic clear window (Altuglas MI-7-101)
- Mounting-Screws, Velcro or Double sided tape.
- Weight: 0.95 oz. (27g)

Tests and Certifications:

- Emissions: (CISPR11:2003 + A1:2004, Group1)
- Radiated: Class B
- ESD (Cenelec EN61000-4-2:1995+A1:1998+A2:2001)
- +/- 4kV contact
- +/- 4kV air
- Conducted RF: (Cenelec EN61000-4-6:2007)
- 150kHz to 80MHz 3Vrms, 1kHz 80%AM
- Magnetic Fields: (Cenelec EN61000-4-8:1993+A1:2001)
- 3A/m at 50Hz
- Agency approvals: CE

OEM Options

- Pick and choose 1 or more functions
- Custom Printing and Logo
- Packaging: Carded, individual box, bulk in trays, polybagged or special kits.

Installation:

1. Find a convenient mounting location; be sure the pickup-wire reaches the spark plug wire or plug-in-coil module. Do Not mount meter where surface temperature exceeds 125F.
2. Pull the pickup wire from the bottom of the meter through the pickup hole. Feed the end of the wire down into the adjacent dead end hole and pull tight. Determine if the pickup wire will exit from the front or the left bottom of the meter.
3. Mount the meter with screws, double sided tape, or Velcro. If using screws, use the meter to make a template for drilling holes with 7/64" drill bit. **DO NOT DRILL** into **GAS TANKS** or **ENGINE CRANKCASE**: If in doubt, contact your dealer. Secure with screws.
4. Spark plug hookup: For spark plug wire hookup, wrap the end of the pickup wire 3-4 times around the **OUTSIDE** of the sparkplug wire and secure it with a tie wrap. For plug-in-coil module, wrap the pickup wire several times around the module and secure it with a tie wrap.